

WARNING!

SECTIONS OF THE ASSEMBLY MARKED  ARE NOT SHIELDED AND MUST BE SHIELDED BY AN INTERACTIVE GUARDING SYSTEM. BINACCHI S.p.A. DECLINES RESPONSIBILITY IF PROPER GUARD ARE NOT PROVIDED OR MAINTAINED.



TIPO-TYPE
TYP

B2

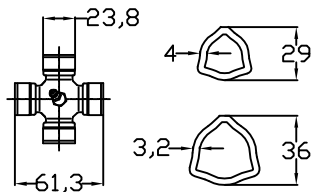

CLIENTE-CUSTOMER-CLIENT-KUNDE

DANI-TECH A/S -DK- per GMR

DATA

12/06/14

RIF.CLIENTE-CUSTOMER REF.-REF.CLIENT-BEZUG KUNDE

64-101-211

TIPO DI MACCHINA-TYPE OF IMPLEMENT-TYPE DE MACHINE-MASCHINENTYPE

VISTO

MODIFICHE-MODIFICATIONS-ÄNDERUNGEN-MODIFICACIONES

POTENZA : 21 Cv (540 g/min)
 COPPIA : 270 Nm (540 g/min)

NOTE :



CODICE C.E.D.
 B2N101CEA60A60